

# GARDEN OF THE CHRISTUS

SECTION ONE  
A SUBDIVISION OF  
KNOLLWOOD MEMORIAL GARDENS  
FIRST ADDITION  
CROW WING COUNTY, MINNESOTA  
CROW WING MEMORIAL GARDENS ASSOCIATION

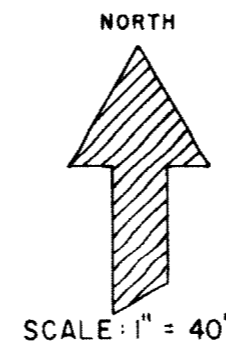

KNOW ALL MEN BY THESE PRESENTS that Crow Wing Memorial Gardens Association, a corporation of Crow Wing County Minnesota, Owner and proprietor of the property as shown on the annexed plat and situated in the East One Half (E 1/2) of the Southwest Quarter (SW 1/4) of Section Twenty three (23) Township One Hundred Thirty-four (134) North, Range Twenty-eight (28) West, Have caused the same to be surveyed and platted as GARDEN OF THE CHRISTUS, SECTION ONE (1) A SUBDIVISION OF KNOLLWOOD MEMORIAL GARDENS FIRST ADDITION and the said corporation hereby dedicate to the public for the public use the Drives and Walks as shown on the annexed plat. In witness whereof said corporation have caused these presents to be signed by its proper officers and its corporate seal to be hereunto affixed on this 19th day of March A.D. 1953.

In the presents of  
Allen T. Rorem and Suzanne C. Ebert  
Allen T. Rorem and Suzanne C. Ebert  
Signed  
Crow Wing Memorial Gardens Association  
Allen T. Rorem President  
Suzanne C. Ebert Secretary

STATE OF Minnesota } ss  
COUNTY OF Hennepin }  
On this 19th day of March A.D. 1953, before me a notary public within and for said County and State personally appeared Allen T. Rorem to me personally known, who being by me duly sworn did say that he is president of the corporation named in the forgoing instrument, and that the seal affixed to said instrument is the corporate seal of said corporation and that said instrument was signed and sealed in behalf of said corporation by authority of its Board of Directors, and that said Allen T. Rorem acknowledges said instrument to be the free act and deed of said corporation.

Notary Public Dorothy E. Nelson  
My Commission Expires June 5, 1959  
DOROTHY E. NELSON  
Notary Public, Hennepin County, Minn.  
My Commission Expires June 5, 1959

STATE OF Minnesota } ss  
COUNTY OF Hennepin }  
On this 19th day of March A.D. 1953 before me, a notary public within and for said County and State, personally appeared Suzanne C. Ebert to me personally known, who by me duly sworn did say that she is Secretary of the corporation named in the forgoing instrument, and that the seal affixed to said instrument is the corporate seal of said corporation and that said instrument was signed and sealed in behalf of said corporation by authority of its Board of Directors, and that said Suzanne C. Ebert acknowledges said instrument to be the free act and deed of said corporation.

Notary Public Dorothy E. Nelson  
My Commission Expires June 5, 1959  
DOROTHY E. NELSON  
Notary Public, Hennepin County, Minn.  
My Commission Expires June 5, 1959

I hereby certify that I have surveyed and platted the property as shown on the annexed plat as GARDEN OF THE CHRISTUS, SECTION ONE (1) A SUBDIVISION OF KNOLLWOOD MEMORIAL GARDENS FIRST ADDITION, that this plat is a correct representation of said survey and that all distances are correctly shown on said plat in figures denoting feet and decimals of a foot. Dated this 17th day of March A.D. 1953.

G. E. Sautter  
Registered Land Surveyor Minnesota Registration No 2584

STATE OF MINNESOTA } ss  
COUNTY OF HENNEPIN }  
The above certificate was subscribed and sworn to before me, a notary public within and for said County and State, on this 17th day of March A.D. 1953

Notary Public, Hennepin County, Minnesota John A. Peterson  
My Commission Expires Nov. 7, 1958  
JOHN A. PETERSON  
Notary Public, Hennepin County, Minn.  
My Commission Expires Nov. 7, 1958

I hereby certify that the taxes have been paid on the above described lands for the years prior to 1952.  
M. H. Fisher  
Auditor, Crow Wing County, Minnesota  
I hereby certify that the taxes have been paid on the above described lands for the years prior to 1952.  
S. C. Ebert  
Treasurer, Crow Wing County, Minnesota

Approx. Centerline of State Trunk Highway No. 218 also the West line of the East 1/2 of the SW 1/4 of Sec. 23, T. 134 N., R. 28 W.

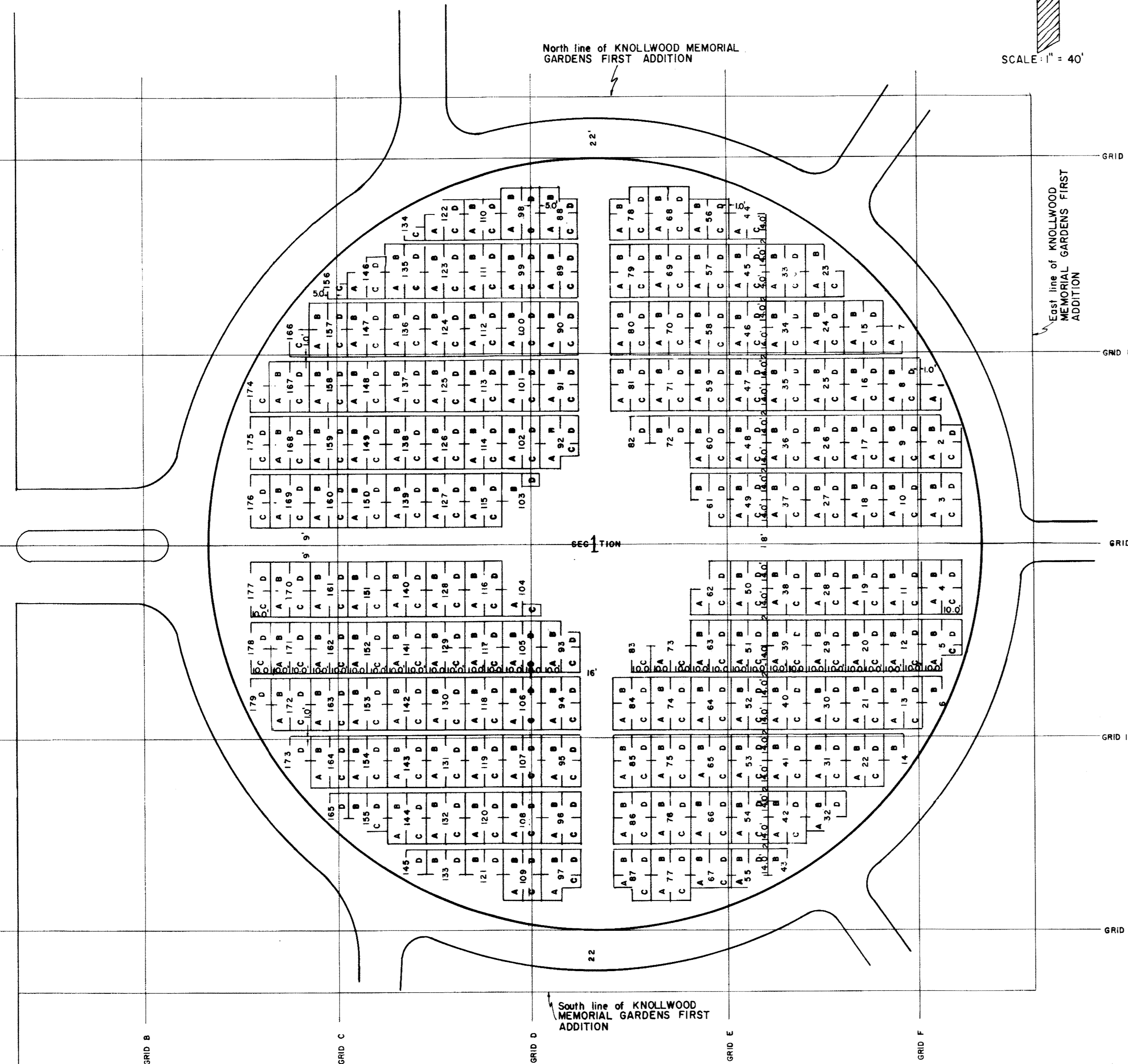

166584  
The map of GARDEN OF THE CHRISTUS, SECTION ONE, A SUBDIVISION OF KNOLLWOOD MEMORIAL GARDENS FIRST ADDITION to the County of Crow Wing, Minnesota, was filed for record in my office this 22nd day of March 1953 at 9 o'clock A.M.  
G. W. Jenkins  
Register of Deeds Crow Wing County, Minnesota

NOTE: THE RED LINES SHOWN HEREON ARE GRID LINES AND ARE ONE HUNDRED FEET APART IN ALL CARDINAL DIRECTIONS WITH GRID 12, GRID 12 BEING A LINE PARALLEL WITH AND 233.25 FEET NORTH OF THE SOUTH LINE OF KNOLLWOOD MEMORIAL GARDENS FIRST ADDITION, AND GRID A BEING THE WEST LINE OF EAST 1/2 OF THE SW 1/4 OF SEC. 23, T. 134 N., R. 28 W.